

产品参数			
频道	10 channels	系统频率响应	20-20KHz
接收灵敏度	<-110dBm@20dB SINAD	失真度	<0.05%
信噪比	>85dB	传输距离	30-50m
延迟	<2ms	满电工作时间	5-6小时(因环境而异)

**无线系统**  
- 这是一款迷你无线收发系统，适用于6.35mm的音频接口设备，具有抗干扰能力强、穿透障碍物强、稳定传输不卡顿等优点。为了避免信号衰减，无线系统应尽量靠近演出区，并置于空旷、通风、避开障碍物至少保持2米的距离，并设置接收发射器与接收器之间有空旷的信号直射路径。演出前请仔细检查电池电量是否充足，避免因电量不足而无法使用。

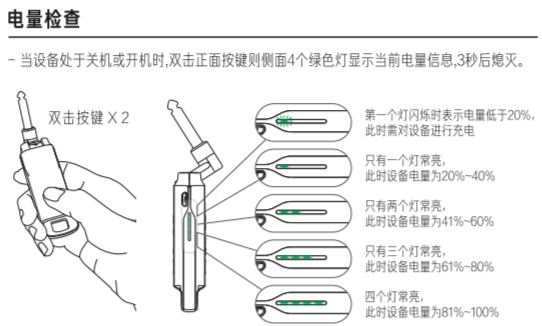

**设备充电**  
- 设备使用的是聚合物锂电池，使用前请先给设备进行充电；长时间不使用，一个月给产品充电一次激活。

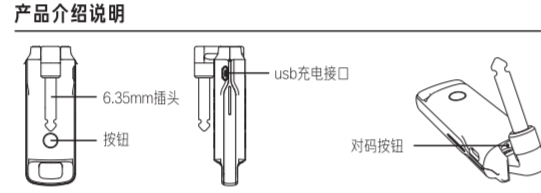
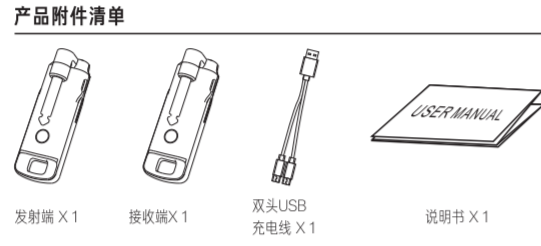
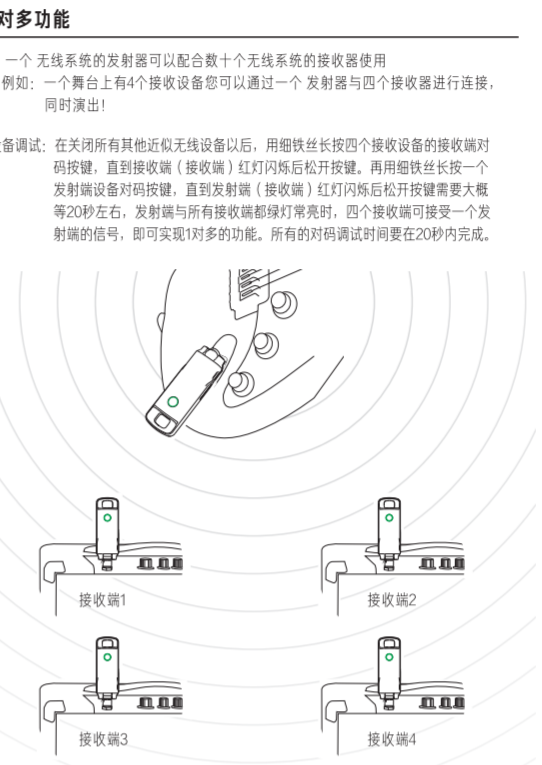
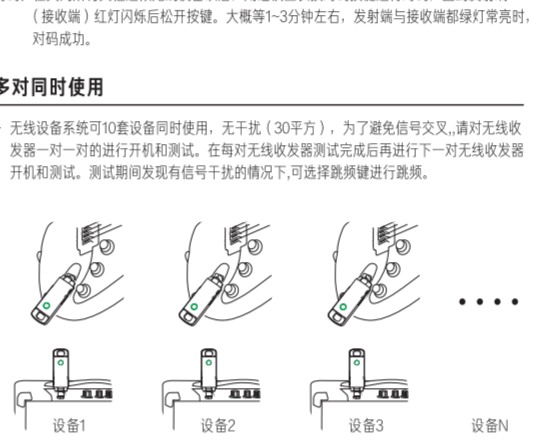
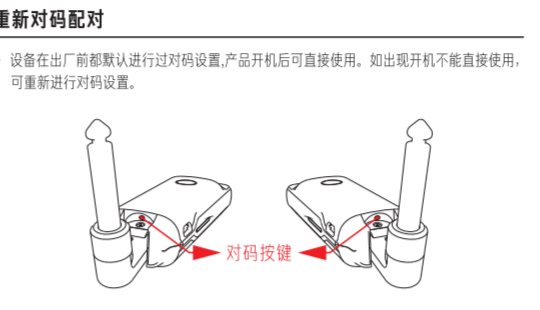
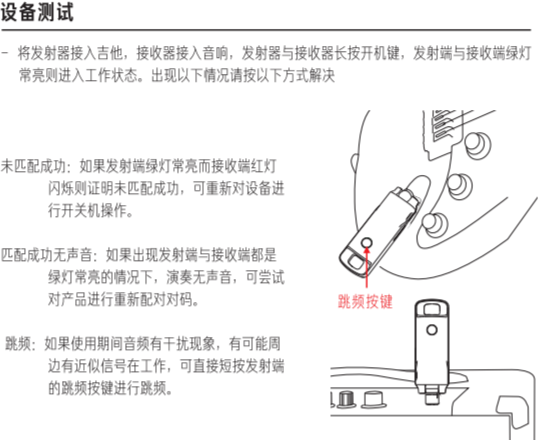
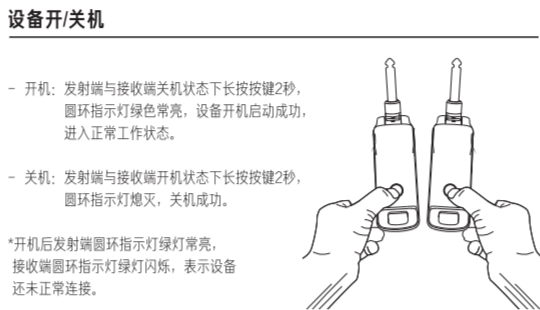
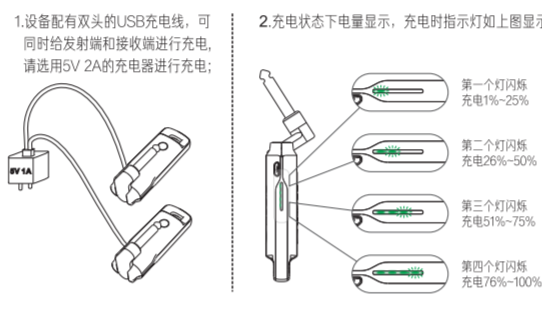

**产品保修卡**

**尊敬的用户：**  
感谢您使用本公司的产品，为了保护您的合法权益，免除您的后顾之忧，同时为改善对客户的售后服务，我公司按照《消费者权益保护法》的有关规定，特制定本保修条例，请您认真阅读并提供宝贵的意见和建议。

一、本公司产品享有自售出之日起一年的免费保修服务。  
二、送修产品请妥善包装运送，运送过程如有损毁或丢失，本公司恕不赔偿。  
三、在免费保修期内，发生下列事项者，本公司有权拒绝服务或酌情收取材料、服务费。  
1. 用户使用或保管不当造成产品故障或损坏的；  
2. 私自拆卸产品的；  
3. 未按产品说明书要求正确使用的；  
4. 意外因素或人为损坏，如进水、摔坏等。  
四、超过保修期后，修理的材料费用及修理费等由用户承担。  
五、使用本公司的产品前请认真阅读产品说明书。  
六、保修卡务必请售机单位盖章及注明日期，并妥善保存以确保您的权益。

产品序列号	购买日期
姓名	
地址	
电话	
经销商名称(盖章)	

\*注：如需售后维修时，请携带此卡。

**Warranty**

Thank you for using our products. In order to protect your legitimate rights and interests, remove your worries and improve the after-sales service to customers, our company has formulated this warranty regulation in accordance with the relevant provisions of the Consumer Rights and Interests Protection Law. Please read carefully and provide valuable comments and suggestions.

1. The products of the company are entitled to one year free warranty service from the date of sale.  
2. Please pack and deliver the products properly. We will not be responsible for any damage or loss in the process of delivery.  
3. During the free warranty period, the Company shall have the right to refuse service or charge materials and service fees at its discretion if any of the following matters occur.  
① Product failure or damage caused by user's improper use or storage;  
② Disassembling the product without permission;  
③ Fail to use correctly according to the product instructions;  
④ Accidental factors or man-made damage, such as water, broken, etc.  
4. After the warranty period is expired, the cost of repairing materials and repair fees shall be borne by the user.  
5. Please read the instructions carefully before using our products.  
6. The warranty card must be stamped and dated by the seller, and properly kept to ensure your rights and interests.

PRODUCT SERIAL NUMBER	PURCHASE DATE
NAME	
ADDRESS	
TEL	
SIGNATURE/DEALER STAMP	

\* Note: Please bring this card with you when you need after-sale maintenance.

**! Please read the instructions carefully before using this product**

warning: In order to reduce the risk of fire or electric shock, please do not put the equipment in the rain or wet place.  
Note: please do not disassemble the equipment without permission. There is no part that can be repaired by the user. Please hand it over to qualified maintenance personnel, please consult your dealer.

- Please use the attached charging line for charging. If you are unsure of the type of power available, please consult your dealer.
- The device has a built-in lithium battery. Please do not put it into the fire or near the heat source.
- This equipment is not waterproof, do not put into water or other liquids.
- Please do not attempt to repair the equipment, because open the lid after may make you touch the danger point voltage or other risks, this equipment is the need for maintenance, please to qualified maintenance personnel for repair.
- If you are not using this product for a long time, you should unplug the charging cable.
- Avoid the power cord being trampled or the position of the socket and the connecting device being too tight at the plug.

**! 请在使用本产品前请仔细阅读说明**

警告：为了减少火灾或者触电的危险，请勿将本设备置于雨中被潮湿的地方  
注意：请勿私自拆卸本设备，内部没有用户可以维修的部件，请交给合格的维修人员处理

- 请使用附带的充电线进行充电，如果不确定可用的电源类型，请咨询您的经销商。
- 本设备内置锂电池，请勿投入火中或热源的附近。
- 本设备没有防水功能，请勿投入水中或其他液体中。
- 请勿尝试自行维修本设备，因为打开盖子后可能会使您接触到危险电压点或其他风险。如果本设备需要进行维修，请交给合格的维修人员进行维修。
- 如果您长时间不使用本产品的时候，应该拔掉充电线。
- 避免电源线被踩踏或者在插头处堵塞和连接设备的位置塞的太紧。

中国制造 CE RoHS REACH

**specification**

Channel	10 channel	System frequency response	20-20KHz
Distortion	<0.05%	Reception sensitivity	<-110dBm @20dB SINAD
Signal-to-noise ratio	>85dB	Transmission distance	30-50m
Latency	< 2 ms	Full working hours	5-6 hours(circumstantial)

**Wireless System**

- It is a mini wireless system, apply with 6.35mm audio devices, with strong anti-interference ability, through the obstacles of strong, stable transmission no pause etc in order to avoid signal attenuation, wireless system should be close to acting area as far as possible, and with a large metal, wall, scaffolding and other objects at least keep a distance of 1.5 meters, and as far as possible to ensure that between transmitter and receiver an empty signal direct way. To avoid being unable to use due to low battery, please kindly check the batteries are good before use.

**Package contents**

